

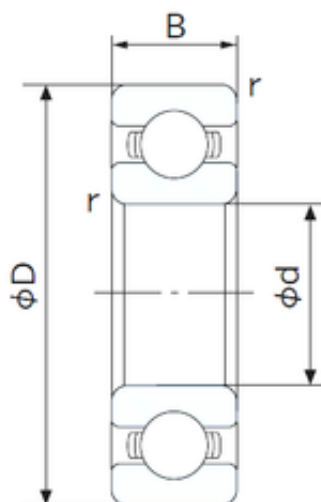

LINEAR BEARINGS CO.,LTD



85 mm x 180 mm x 41 mm NACHI 6317 deep groove ball bearings

Bearing No. 6317

6317 Bearing 2D drawings and 3D CAD models

Size	85x180x41 mm
Bore Diameter	85 mm
Outer Diameter	180 mm
Width	41 mm
d	85 mm
D	180 mm
B	41 mm
C	41 mm
r min.	3 mm
da min.	99 mm
Da max.	166 mm
ra max.	2.5 mm
Weight	4.23 Kg
Basic dynamic load rating (C)	133 kN
Basic static load rating (C0)	96,5 kN
(Grease) Lubrication Speed	3600 r/min
Category	Single Row Ball Bearings
Inventory	0.0
Manufacturer Name	NACHI
Minimum Buy Quantity	N/A
Weight / Kilogram	0
Product Group	B00308
Enclosure	Open
Precision Class	ABEC 1 ISO P0
Maximum Capacity / Filling	No



LINEAR BEARINGS CO.,LTD

Slot	
Rolling Element	Ball Bearing
Snap Ring	No
Internal Special Features	No
Cage Material	Steel
Internal Clearance	C0-Medium
Inch - Metric	Metric
Long Description	85MM Bore; 180MM Outside Diameter; 41MM Outer Race Width; Open; Ball Bearing; ABEC 1 ISO P0; No Filling Slot; No Snap Ring; No Internal Special Features; C0-Medium Internal Clearance; Steel Cage
Other Features	Deep Groove
Category	Single Row Ball Bearing
UNSPSC	31171504
Harmonized Tariff Code	8482.10.50.68
Noun	Bearing
Keyword String	Ball
Manufacturer URL	http://www.nachiamerica.com
Bore	3.346 Inch 85 Millimeter
Outside Diameter	7.087 Inch 180 Millimeter
Outer Race Width	1.614 Inch 41 Millimeter
Inner Race Width	0 Inch 0 Millimeter
Bore Type	Cylindrical Bore
Configuration	Single Row
Bore Size	85 mm
Width	41 mm
Fillet Radius/Chamfer	3 mm
Dynamic Load Rating	133,000 N
Static Load Rating	96,500 N



LINEAR BEARINGS CO.,LTD

Limiting Speed - Grease	3,800 rpm
Limiting Speed - Oil	4,500 rpm
Factor f_0	13.3
Radial Clearance	0.012 to 0.036 mm
d_a (min)	99 mm
D_a (max)	166 mm
r_a (max)	2.5 mm